



# LED WALL PACK LIGHT

40/60/80/120W

WP01B

**SUPERTEK**  
SMARTLED



## QUICK FACTS

1. ETL, DLC5.1 Premium listed
2. 120-277Vac optional
3. High efficacy up to 140LM/W
4. CCT and wattage tunable available
5. Microwave motion, photocell sensor / Emergency battery backup optional
6. Traditional design, strong extruded lamp body
7. Lifespan: >50,000Hrs
8. 5 years warranty



## SPECIFICATIONS

NOTE MARK	MODEL	WATT	EFFICACY	LUMENS	REPLAC HID	AVAILABLE CCT
Single Wattage Single CCT	WP01B-40-50K-LV	40W	140LPW	5,600LM	100-150W	3000/4000/5000K
Multiple Wattage Single CCT	WP01B-60MW-50K-LV	60/40/25/20W	140LPW	8,400LM	175-250W	3000/4000/5000K
	WP01B-120MW-50K-LV	120/100/80/60W Tunable	140LPW	16,800LM	320-400W	3000/4000/5000K
Multiple Wattage Multiple CCT	WP01B-80MW-50KMC-LV	80/60/40/25W Tunable	140LPW	11,200LM	175-250W	3000/4000/5000K Tunable
	WP01B-120MW-50KMC-LV	120/100/80/60W Tunable	140LPW	16,800LM	320-400W	3000/4000/5000K Tunable

Note: LV=120-277V / MW=Multiple Wattage / MC=Multiple CCT

### Electrical Data

Input Voltage	120-277Vac
Power Factor	0.90
Power Frequency	50/60Hz
Power Efficiency	>90%
Total Harmonic Distortion	<15%
Dimming	0-10V
Driver	Kerham
Surge Protection	L-N: 4KV; L/N-PG: 6KV

### Optical Data

Efficiency	140 LM/W
LED	3030
CCT	2700-6500K
CRI	> 70
Beam Angle	110°×105°
Additional function	CCT & Wattage Tunable; Photocell; Emergency Battery Back Up; Pluggable Microwave Motion Sensor

### Others

IP Rating	IP65
Life Time	>50,000Hrs (Ta=30°C@L80)
Warranty	5 Years
IK Degree	08
Housing	Die-cast Aluminum
Operating Temperature	-40°F to 104°F (-40°C to +40°C)
Certificates	ETL/DLC 5.1 Premium
Finish	Black/Bronze/White Customized (Optional)

# SPECIFICATION FEATURES

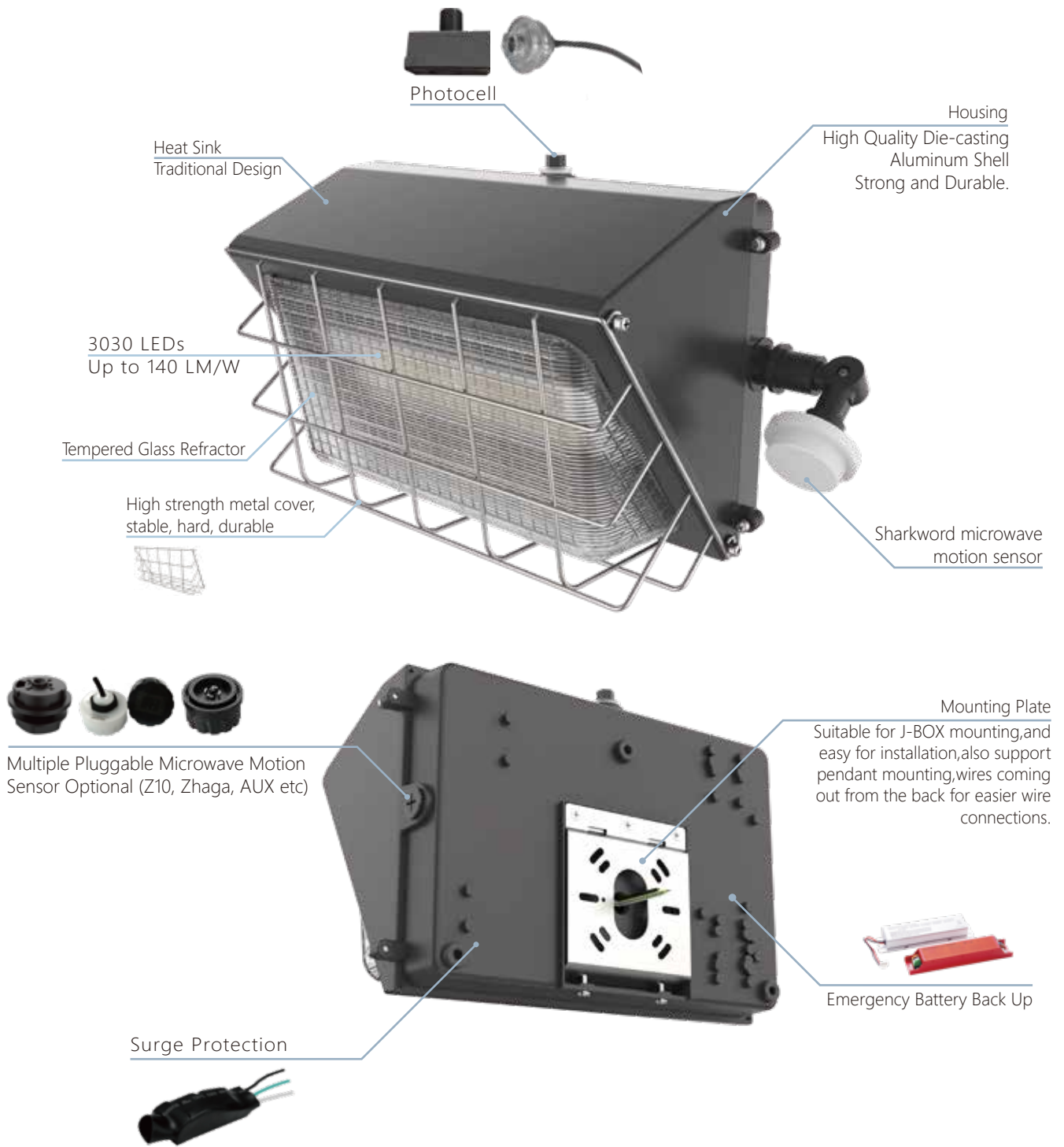

## Wattage & CCT TUNABLE

### CCT

3000K  
4000K  
5000K

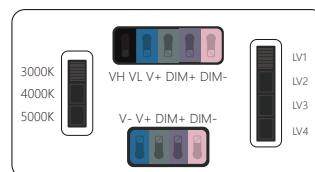

### WATT

FOR: 120W    FOR: 80W

60W	25W
80W	40W
100W	60W
120W	80W

## PHOTOMETRIC DIAGRAMS

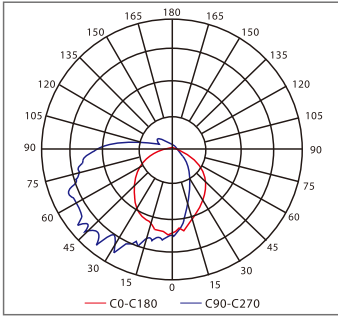

## DIMENSIONS INCH (MM)

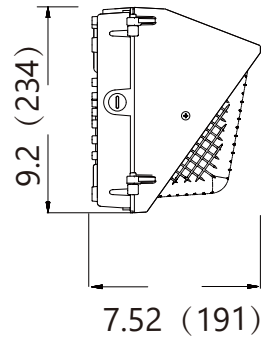
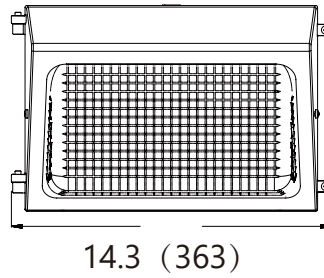

## INSTALLATION METHODS

### Normal Version



Open fixture, mount back plate to junction box or wall.



Hang housing on hinges and make connection.



Close housing and tighten screws.

### Quick Mount Version

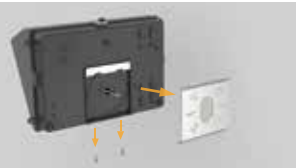

Open fixture, mount back plate to junction box or wall. Hang housing on hinges and make connection. Close housing and tighten screws. The installation is complete.



Using a Phillips head screw driver remove set screws from bottom of mounting plate. Attach mounting plate to junction box. Connect wires to hot, neutral, and ground. Slide fixture downward on to mounting plate and replace set screws removed in step one.



## PARKING INFORMATION

MODEL	MASTER CARTON (MM & INCH)	PCS CTN	NET WEIGHT (KGS & LBS)	GROSS WEIGHT (KGS & LBS)	20GP PCS	40HQ PCS	45HQ PCS
WP01B-40	390*260*230 15.35*10.24*9.06	1	3.6 / 7.94	4.2 / 9.26	1,108	2,691	4,875
WP01B-60	390*260*230 15.35*10.24*9.06	1	3.6 / 7.94	4.2 / 9.26	1,108	2,691	4,875
WP01B-80	390*260*230 15.35*10.24*9.06	1	3.6 / 7.94	4.2 / 9.26	1,108	2,691	4,875
WP01B-120	390*260*230 15.35*10.24*9.06	1	4.7 / 10.94	5.3 / 11.68	1,108	2,691	4,875